



Ultra Trap

Ultracoustic

Installation Guide

Congratulations!

Congratulations on purchasing the Ultra Trap Acoustic Basstrap from Ultracoustic. The Ultracoustic Ultra Trap Basstrap is a package of easy to install acoustic panels, that will effectively absorb Low frequencies and look great for years to come. The Ultra Trap Basstrap are ideally suited to provide effective acoustic control in applications as diverse as home-theatres, practice rooms, house of worship & broadcast studios. Please take a few minutes to read through this install manual. It includes a list of parts as well as step by step mounting instructions. Please refer to www.ultracousticin.com for various placement options, benefits and general room acoustic information.

Should you have any questions or comments, we invite you to send us an email at : info@ultracousticin.com

Installation Instructions:

Wall surfaces should be examined prior to installation, ensuring they are clean, smooth, and dry. The surface should be solid wall eg. brick or concrete wall.

INSTALLING ULTRA TRAP WITH FRENCH CLEAT SYSTEM.

ULTRACOUSTIC french cleat system are designed to provide the installer with a simple and effective method of mounting Ultra Trap onto walls. The french cleat system feature a male - female arrangement.

STEP 1 : Mark the position of basstrap where it is going to be installed. Measure the angled wooden piece on the back of panel from top of the panel. Mark the same position on the wall markings. Use a bubble level to make a straight pencil line

STEP 2 : Keep the loose wooden piece given with the panel and hold it at the marking. The angle should be opposite of the wooden piece on basstrap.

STEP 3 : Drill Holes on the wall after marking the holes on the wooden piece. Screw the wooden piece in place. Make sure it's tightly screwed.

STEP 4: pick up the basstrap and Hang it on the wooden piece.

Installation Steps:

1.

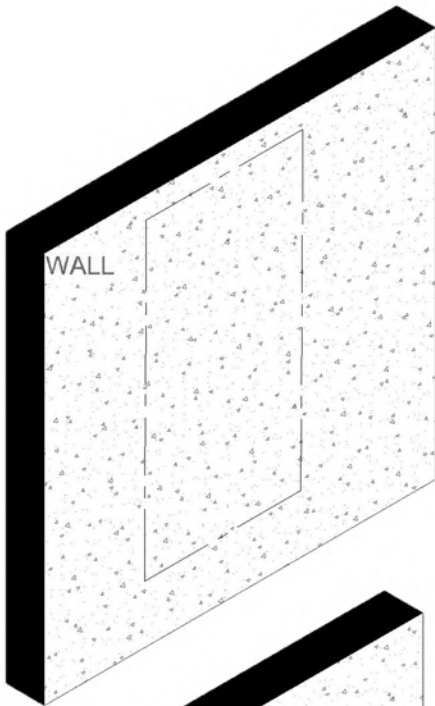

Mark the out of the panel on the wall.

2.

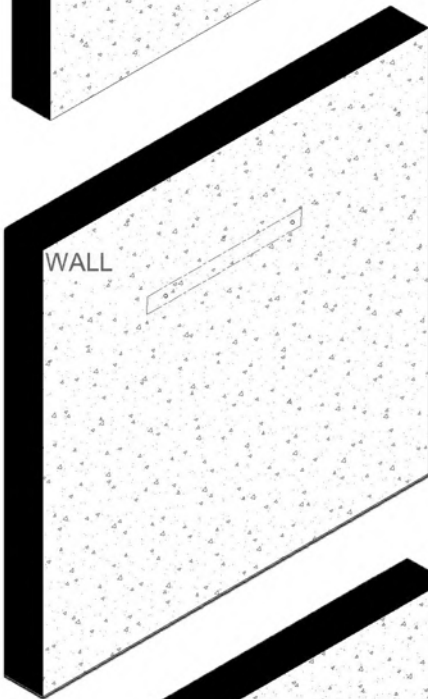

Beveled Wooden Piece
Placed the Bevel on wall

Mark the position of given beveled wooden piece. According to the Basstrap beveled panel.

3.

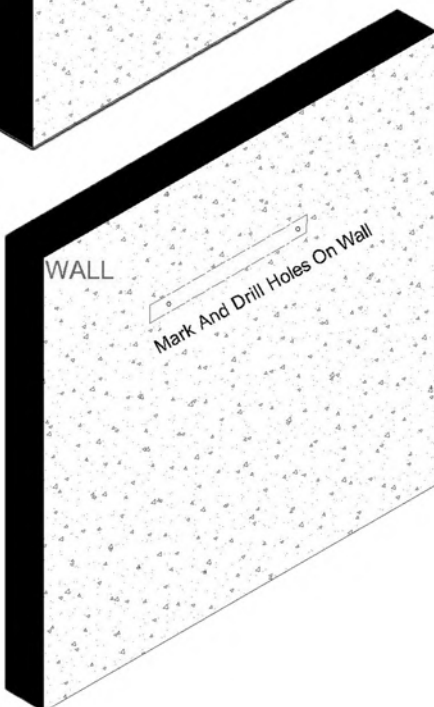

Mark and drill hole in the wall as given on the loose wooden piece.

4.

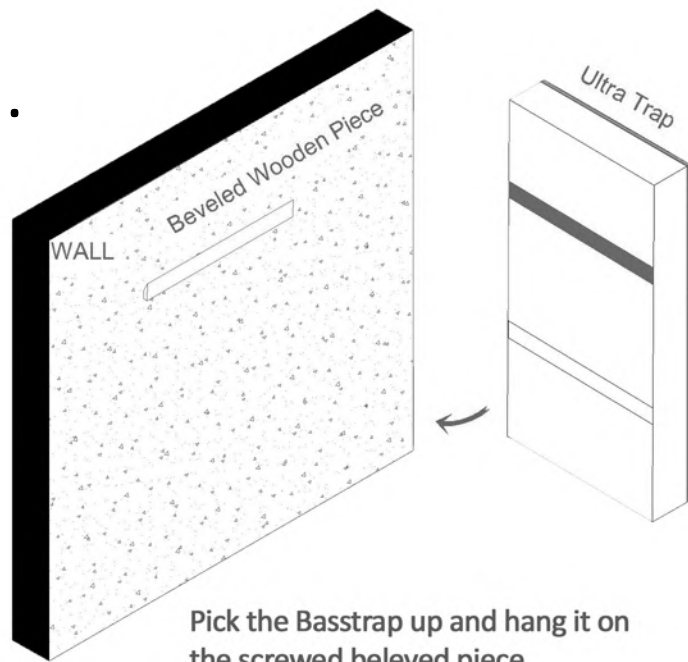

Pick the Basstrap up and hang it on the screwed beveled piece.

5.

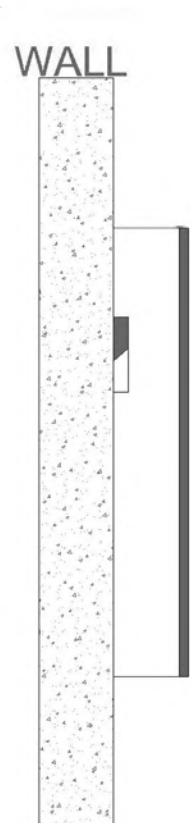

The beveled piece should sit as shown above.

Warranty:

Please inspect panels immediately after purchase and before mounting.

Ultracoustic acoustic panels are guaranteed to be free of manufacturing defects for a period of fifteen (15) days after purchase.

In the unlikely event that a defect is uncovered, please call 91-72089 07208 to obtain RA number from Ultracoustic before the fifteen (15) day warranty period expires.

Once you have obtained an RA number you must return the product, freight prepaid with ten (10) days after the date the RA number is issued.

Please return the product in the original packaging

(or another, affording an equal degree protection) with all of the following:

- (1) RA number clearly marked on the returned package;
- (2) A receipt or bill of sale showing proof of purchase from an authorized retail seller; and
- (3) A written note describing the defect and including your name, address, telephone number and the applicable RA number.

You are solely responsible for all shipping and insurance costs returning the product to Ultracoustic and you will not be reimbursed or compensated for any loss or damage incurred during return shipping. Ultracoustic will at its discretion repair or replace the panel.

Should the panel be no longer available, Ultracoustic reserves the right to exchange this with a panel of similar performance and value. Due to different dye lots, Ultracoustic cannot guarantee exact colour match. This Warranty shall solely extend to the original owner and is limited to manufacturing defects only and excludes damage due to improper installation, freight handling, wear and tear, abuse, misuse, Misapplication, colour fading or deterioration due to prolonged exposure to ultra violet light, smoke, humidity or other environmental factors. It is understood that the use and suitability of our acoustic panels is entirely the responsibility of the buyer or specifying engineer and as such, these parties agree to hold Ultracoustic, or its associated company, and/or offers, harmless from any responsibility whatsoever other than what is clearly outlined in the warranty.

Contact Us:

Address:

Ultracoustic is a division of A R Acoustics LLP. 504, Jupiter, Gaurav Galaxy, Phase II, Mumbai - 401107.

Telephone No:

(9122) 6560-6002 | 2945 1202

Mobile No.: 72089 07208

Email: info@ultracousticin.com

Follow us on: <https://www.instagram.com/ultracoustic/?hl=en>

Specifications and appearances subject to change without notice.

Ultracoustic Ultra Trap manual rev.007 / Part #: R360-xxx-xx Copyright © 2015 All rights reserved.

www.ultracousticin.com