

# Installation Steps:

1.

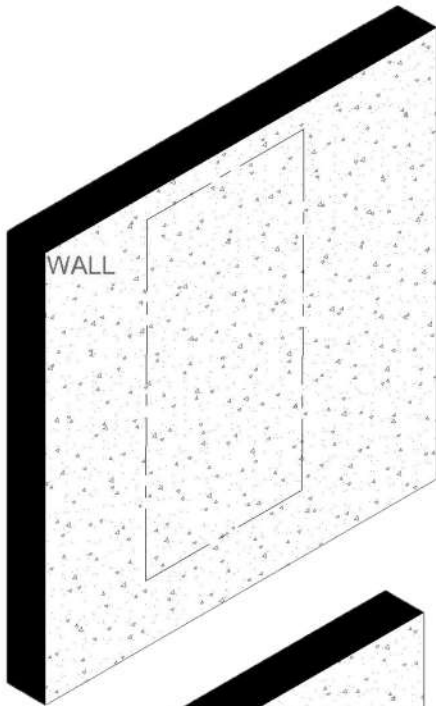

Mark the out of the panel on the wall.

2.

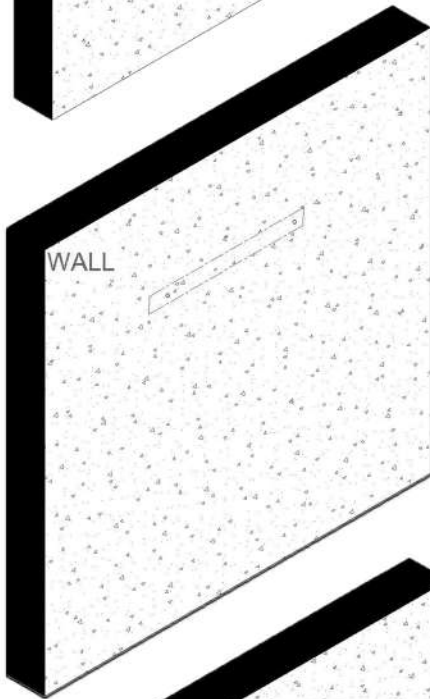

Beveled Wooden Piece  
Placed the Bevel on wall

Mark the position of given beveled wooden piece. According to the Basstrap beveled panel.

3.



Mark and drill hole in the wall as given on the loose wooden piece.

4.

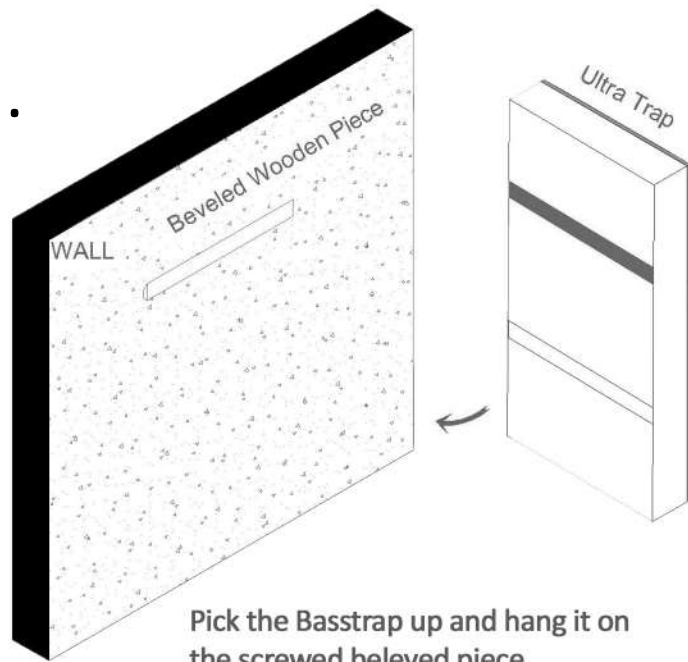

Pick the Basstrap up and hang it on the screwed beveled piece.

5.

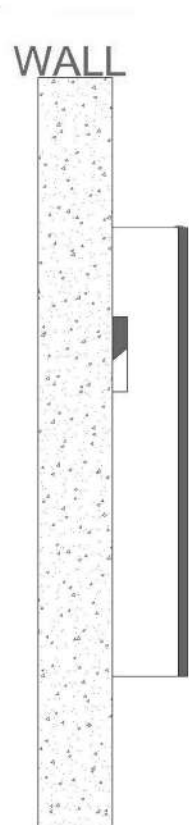

The beveled piece should sit as shown above.